

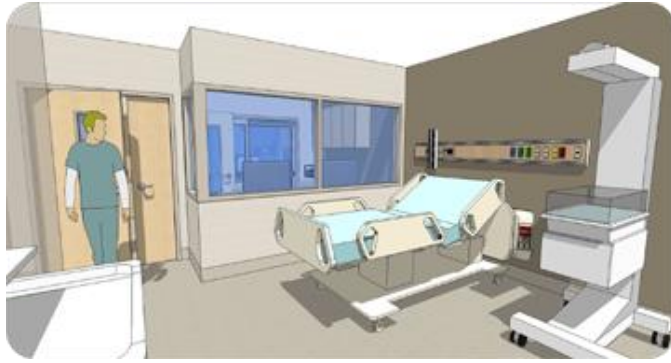

## TD Bank Group donation invests in simulation training

August 10, 2015



*Concept rendering - The planned training centre for Women's and Children's Simulation Training Program on the third floor of Zone B at Victoria Hospital replicates a realistic patient care environment. It includes two birthing rooms with control rooms (shown), a third simulation practice area, a debriefing room and dedicated storage for hi- and low-fidelity simulation devices.*

**London, Ont.** - "See one, do one, teach one" has long been a recognized component of medical education and training – meaning health care

professionals learn, in part, by observing and practicing in real patient-care situations.

While real-life experience is still important, technology now enables London Health Sciences Centre to conduct sophisticated simulation training that enhances and expands on that model; even allowing multidisciplinary health care teams to practice less-common and rare critical care scenarios in a risk-free environment.

"Simulation training improves real-world communication, collaboration, teamwork and crisis management in the delivery room, clinic and operating room," says Director of Women's Care Emily Williams. "These dynamics are extremely important when we are providing acute care to the most vulnerable patient populations – including neonatal and obstetrical patients."

The hospital introduced the Women's and Children's Simulation Training Program in 2011 using high- and low-fidelity mannequins that represent different patient groups like newborn and adult obstetrical. The program, which is currently housed in temporary space at Victoria Hospital, trains LHSC personnel as well as clinical teams from community hospitals across the region.

On August 6, TD Bank Group announced a \$500,000 donation to London Health Sciences Foundation's Women's Care Campaign that will provide part of the donor funding required to create a planned, state-of-the-art training centre for the program on the third floor of the North Tower (Zone B).



*\$500,000 gift presentation: (from left) LHSF President & CEO John MacFarlane, LHSC Chief Clinical and Transformation Officer Laurie Gould, TD Canadian Banking & Wealth Management Group Head Tim Hockey, LHSC Director of Women's Care Emily Williams, TD Canada Trust (Western Ontario Region) Senior Vice President Anna Iacobelli, and TD Community Banking Executive Vice President Tom Dyck.*

good health care we take for granted, and make it great."

"We can't thank TD Bank Group enough for investing in our community's health through this generous donation," says LHSF President and CEO John MacFarlane. "Donations like this take the

Education and training is an important focus of TD Bank Group's charitable giving and this dedicated space will enable the Women's and Children's Simulation Training Program to realistically replicate clinical settings, record training sessions and provide detailed debriefings – permitting participants to observe their behaviours during a simulated crisis situation, assess team performance and identify opportunities for improvement.

We're a longstanding community partner of London Health Sciences Centre and Children's Hospital at LHSC," said Tim Hockey, President and CEO, TD Canada Trust, "We know the simulation centre will improve care for moms and children, benefitting families throughout the community which is also a priority for us.

*For more information on donor-supported Women's Care initiatives, please visit [www.lhsf.ca](http://www.lhsf.ca) and click on the Hospital Priorities tab, or contact LHSF Senior Development Officer Simona Dobransky at 519.685.8798, [simona.dobransky@lhsc.on.ca](mailto:simona.dobransky@lhsc.on.ca).*